

2.92mm/2.92mm

# DC - 40GHz, Coaxial Panel Adapters

## DESCRIPTION

These "KPC292MFPA, FMPA, FFPA and MMPA" coaxial panel adapters that 9.5mm "D" holed panel mountable, low SWR and low loss, are designed for broadband measurement, instrument and system use.

## SPECIFICATIONS:

### Electrical:

Frequency Range DC - 40 GHz  
 SWR <1.15  
 Insertion Loss <0.25 dB  
 Electrical Length Below (Nominal)  
 Temperature Range -55 to +125 deg.C

### Mechanical:

Body : Passivated Stainless steel (\*)  
 Outer Conductors: Gold Plated Stainless steel  
 Inner Conductors: Gold Plated Beryllium Copper  
 Coupling Torque 90 N-cm(Nominal)  
 Connect/Disconnect Life >1,000 Cycles



**Production Status**  
 Two weeks Lead-Time will be available for shipping.

### TYPE: KPC292MFPA 2.92mm Male/2.92mm Female

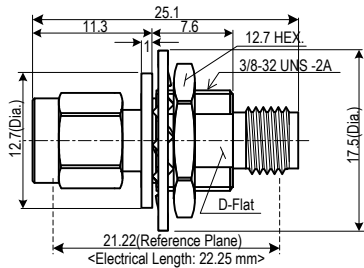

### TYPE: KPC292FMPA 2.92mm Female/2.92mm Male

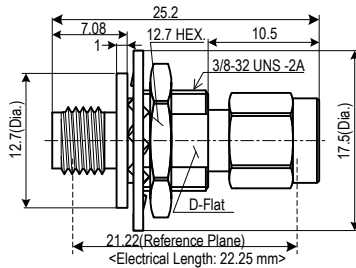

### TYPE: KPC292FFPA 2.92mm Female/2.92mm Female

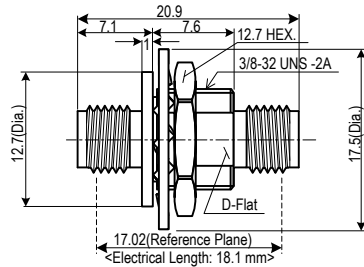

### TYPE: KPC292MMPA 2.92mm Male/2.92mm Male

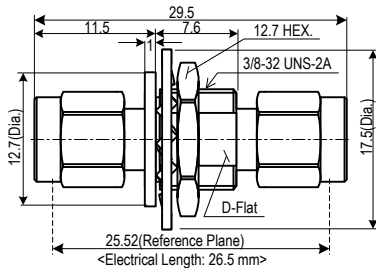

## Typical Performance

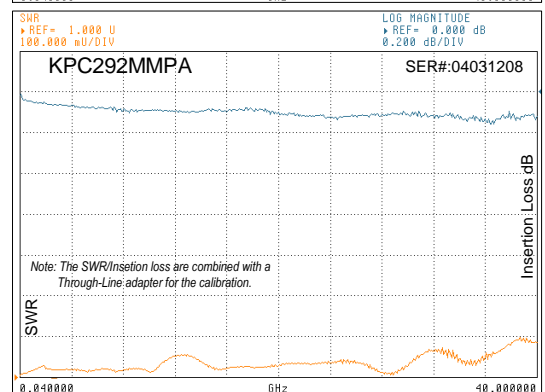
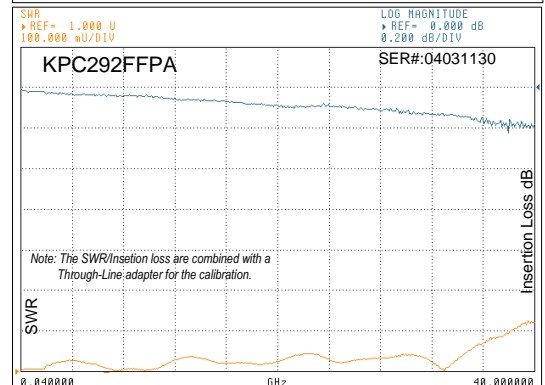
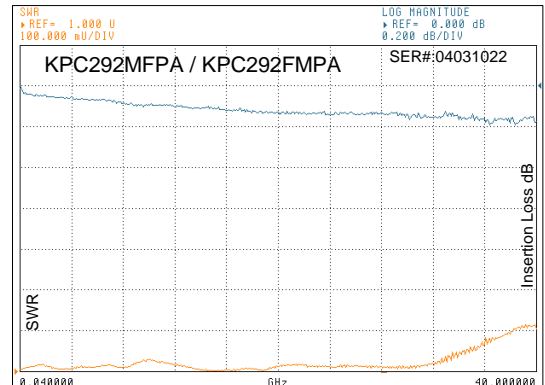

## Interface Mating Dimensions of KPC292 (2.92mm Connectors)

|   |         |
|---|---------|
| a | 1.270   |
| b | 2.920   |
| c | 4.640   |
| d | 4.580   |
| e | 0.920   |
| f | 0-0.050 |
| g | 0-0.050 |

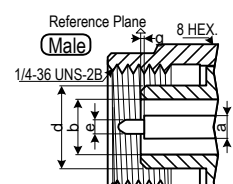
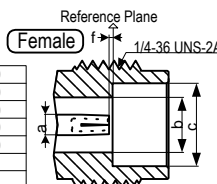

Note:  
 - All dimensions are in Millimeters.  
 - (\*)The toothed lockwasher is chromate converted zinc plated steel.

Specifications Subject to Change Without Notice.

Copyright(C) 2002-2013 KAWASHIMA Mfg. Co., Ltd. All rights reserved.



Kawashima Manufacturing Co., Ltd.

1-3-5 Higashiikuta, Tama-ku,  
 Kawasaki 214-0031 JAPAN

TEL: +81-44-911-7073 FAX: +81-44-911-9621  
 http://www.kmco.biz/ e-mail: sales@kmco.co.jp