

1.85 mm/1.85 mm

DC - 70 GHz, Coaxial Adapters, In-Series

DESCRIPTION

"KPC185MF, FF, and MM"

are small size, low SWR, and low loss coaxial adapters. They are designed for broadband measurement, instrument, and system applications.

SPECIFICATIONS

Electrical:

Frequency Range	DC - 70 GHz
SWR	< 1.3
Insertion Loss	< 0.45 dB
Electrical Length	17.5 mm (Nominal)
Temperature Range	-55 to +125 °C

Mechanical:

Body and Outer Conductor	Passivated or Gold Plated Stainless Steel
Inner Conductor	Gold Plated Beryllium Copper and Brass
Coupling Torque	90 N-cm (Nominal)
Connect/Disconnect Life	> 1,000 Cycles



Production Status
2 Weeks Lead-Time
for Shipping

TYPE: KPC185MF

1.85 mm Male/1.85 mm Female

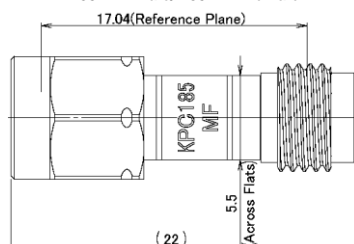

TYPE: KPC185FF

1.85 mm Female/1.85 mm Female

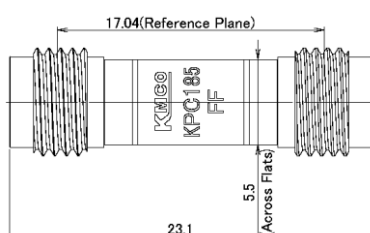

TYPE: KPC185MM

1.85 mm Male/1.85 mm Male

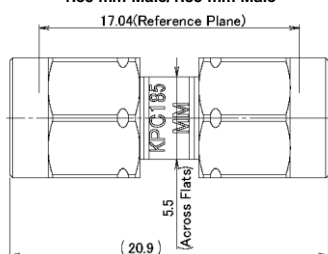

NOTE:

All dimensions are in millimeters.

Interface Mating Dimensions of KPC185 (1.85 mm Connectors <*>)

KPC185(1.85 mm)	
a	φ 0.803
b	φ 1.850
c	φ 4.770
d	φ 4.750
e	φ 0.511
f	0-0.050
g	0-0.050

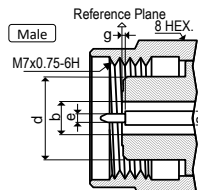
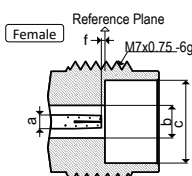

<*> Matable with 2.4 mm connectors

RoHS Compliant

REACH Compliant

Typical Performance

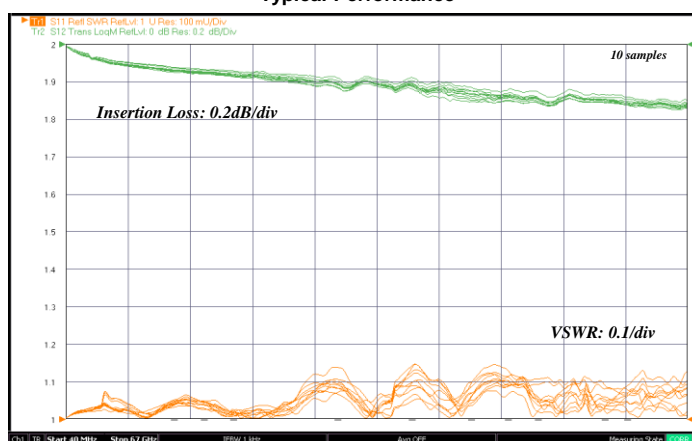

KPC185MF 0.04~70GHz

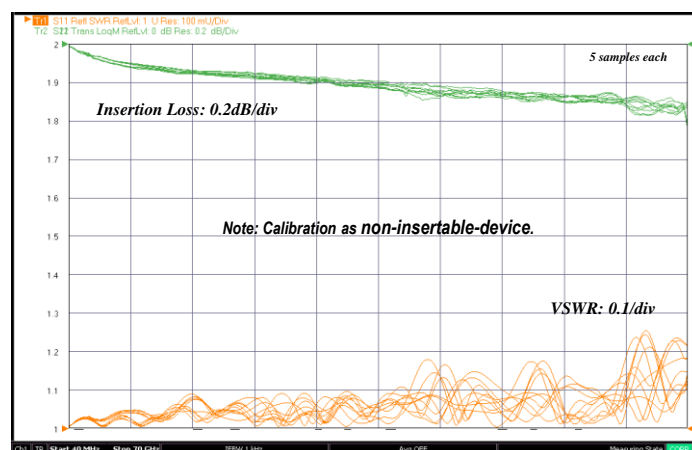

KPC185FF & KPC185MM 0.04~70GHz

Specifications Subject to Change Without Notice

Rev. 04 Feb. 2024

Copyright(C) 2002-2021 Kawashima Manufacturing Co., Ltd. <All rights reserved.>



Kawashima Manufacturing Co., Ltd.

1-3-5 Higashi-ikuta, Tama-ku,
Kawasaki 214-0031 JAPAN

TEL: +81-44-911-7073
https://kmco.co.jp/en/

FAX: +81-44-911-9621
e-mail: sales@kmco.co.jp