

# 3.5 mm/2.4 mm DC - 26.5 GHz, Coaxial Adapters, Between-Series

## DESCRIPTION

"KPC350F240F, KPC350F240M, KPC350M240F, and KPC350M240M" coaxial adapters between 3.5 mm and 2.4 mm are small size, low SWR, and low loss. They are designed for broadband measurement, instrument, and system applications.

## SPECIFICATIONS

### Electrical:

Frequency Range	DC - 26.5 GHz (Moding: 34GHz)
SWR	< 1.2
Insertion Loss	< 0.3 dB
Electrical Length	17.5 mm (Nominal)
Temperature Range	-55 to +125 °C

### Mechanical:

Body and Outer Conductor	Passivated Stainless Steel
Inner Conductor	Gold Plated Beryllium Copper and Brass
Coupling Torque	90 N-cm (Nominal)
Connect/Disconnect Life	> 1,000 Cycles



**Production Status**  
2 Weeks Lead-Time  
for Shipping

**TYPE: KPC350F240F**  
3.5 mm Female/2.4 mm Female

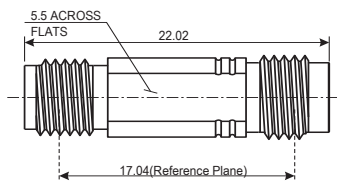

**TYPE: KPC350F240M**  
3.5 mm Female/2.4 mm Male

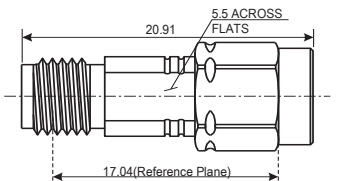

**TYPE: KPC350M240F**  
3.5 mm Male/2.4 mm Female

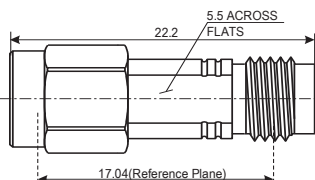

**TYPE: KPC350M240M**  
3.5 mm Male/2.4 mm Male

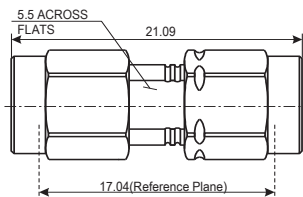

## Typical Performance

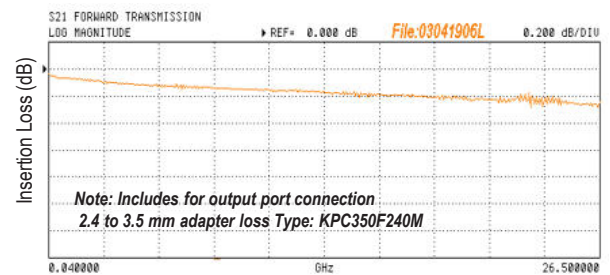
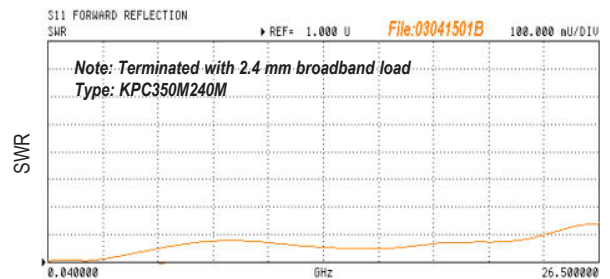

**RoHS Compliant**

**REACH Compliant**

## Interface Mating Dimensions

### KPC350 (3.5 mm Connectors)

KPC350(3.5 mm)	
a	φ 1.520
b	φ 3.500
c	φ 4.640
d	φ 4.580
e	φ 0.920
f	0-0.050
g	0-0.050

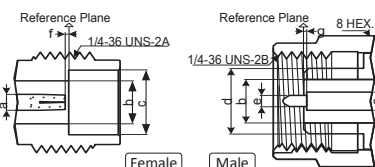

### KPC240 (2.4 mm Connectors <\*>)

KPC240(2.4 mm)	
a	φ 1.042
b	φ 2.400
c	φ 4.770
d	φ 4.750
e	φ 0.511
f	0-0.050
g	0-0.050

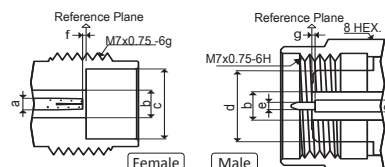

<\*> Matable with 1.85 mm connectors

### NOTE:

All dimensions are in millimeters.

Specifications Subject to Change Without Notice

Rev. 03 June 2017

Copyright(C) 2002-2017 Kawashima Manufacturing Co., Ltd. <All rights reserved.>



**Kawashima Manufacturing Co., Ltd.**

1-3-5 Higashi-ikuta, Tama-ku,  
Kawasaki 214-0031 JAPAN

TEL: +81-44-911-7073  
http://www.kmco.biz/

FAX: +81-44-911-9621  
e-mail: sales@kmco.co.jp