

2.92 mm/1.85 mm DC - 40 GHz, Coaxial Adapters, Between-Series

DESCRIPTION

"KPC292F185F, KPC292F185M, KPC292M185F, and KPC292M185M"

coaxial adapters between 2.92 mm and 1.85 mm are small size, low SWR, and low loss.

They are designed for broadband measurement, instrument, and system applications.

SPECIFICATIONS

Electrical:

Frequency Range	DC - 40 GHz
SWR	< 1.3
Insertion Loss	< 0.35 dB
Electrical Length	17.5 mm (Nominal)
Temperature Range	-55 to +125 °C

Mechanical:

Body and Outer Conductor	Passivated Stainless Steel
Inner Conductor	Gold Plated Beryllium Copper and Brass
Coupling Torque	90 N-cm (Nominal)
Connect/Disconnect Life	> 1,000 Cycles



Production Status
2 Weeks Lead-Time
for Shipping

TYPE: KPC292F185F
2.92 mm Female/1.85 mm Female

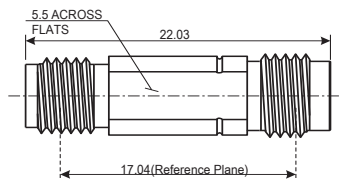

TYPE: KPC292F185M
2.92 mm Female/1.85 mm Male

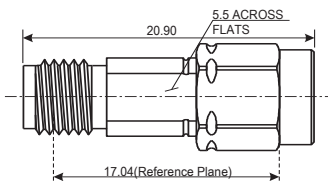

TYPE: KPC292M185F
2.92 mm Male/1.85 mm Female

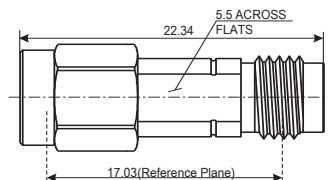

TYPE: KPC292M185M
2.92 mm Male/1.85 mm Male

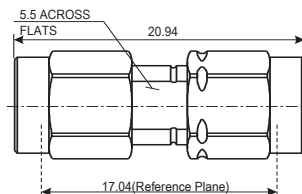

Typical Performance

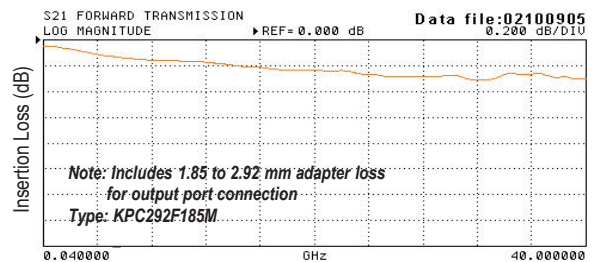
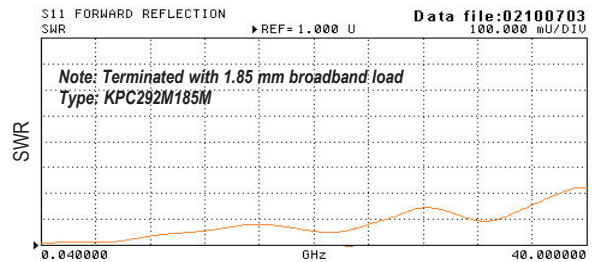

RoHS Compliant

REACH Compliant

Interface Mating Dimensions

KPC292 (2.92 mm Connectors)

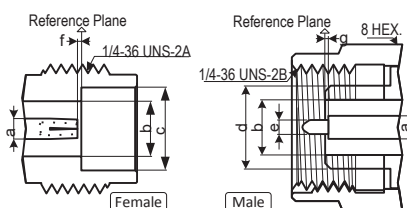

KPC185 (1.85 mm Connectors <*>)

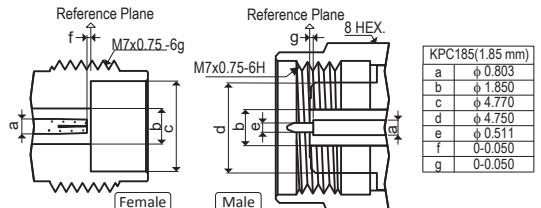

KPC292(2.92 mm)	
a	φ 1.270
b	φ 2.920
c	φ 4.640
d	φ 4.580
e	φ 0.920
f	0-0.050
g	0-0.050

KPC185(1.85 mm)	
a	φ 0.803
b	φ 1.850
c	φ 4.770
d	φ 4.750
e	φ 0.511
f	0-0.050
g	0-0.050

NOTE:

All dimensions are in millimeters.

Specifications Subject to Change Without Notice

Copyright(C) 2002-2017 Kawashima Manufacturing Co., Ltd. <All rights reserved.>

<*> Matable with 2.4 mm connectors

Rev. 03 June 2017



Kawashima Manufacturing Co., Ltd.

1-3-5 Higashi-ikuta, Tama-ku,
Kawasaki 214-0031 JAPAN

TEL: +81-44-911-7073
http://www.kmco.biz/

FAX: +81-44-911-9621
e-mail: sales@kmco.co.jp